

MKD	SILL	LINTEL	SIZE	MKD	SILL	LINTEL	SIZE
DA	-	2400	1800X2400	W	350	2400	4000X2050
D	-	2400	1500X2400	W1	350	2400	2000X2050
DW	-	2400	3000X2400	W2	350	2400	1500X2050
DW1	-	2400	1800X2400	W3	350	2400	900X2050
DW2	-	2400	2825X2400	W4	1050	2400	1200X1350
D1	-	2400	1200X2400	W5	1050	2400	750X1350
D2	-	2400	1100X2400	W6	1500	2400	750X900
D3	-	2400	900X2400	W7	1250	2150	600X900
D4	-	2400	750X2400	W8A	1050	2150	2000X1100
D5	-	2150	1100X2150	W9A	650	2150	775X1500
D3A	-	2150	900X2150	W9	350	2400	1000X2050
D4A	-	2150	750X2150	W10	350	2400	1000X2050
FCD	-	2400	1100X2400	W1	2150	2150	600X800
FCD1	-	2150	1100X2150	SW & SW1	AS PER ELEVATION		

**SHEET NO. 2/17**

**SCHEDULE OF LAND :**

- 1.R.S. KHATHAN NO. 151/1, 862, 155, 180, 152, 623, 624 & 626
- 2.R.R. KHATHAN NO. 66, 68, 69, 70, 71, 102, 112, 113
- 3.R.S. PLOT NO. 471, 472, 483, 958, 478, 483 / 956, 483
- 4.L.R. PLOT NO. 45, 48, 49, 71
5. SITUATED WITHIN MOUZA - DAGGRAM
6. SHEET N - 48
7. J.L. - NO.2
8. WARD NO. - 41(S.M.C.)
9. PRGN. - BAIKUNTHAPUR
10. P.S. - JALPAIGURI
11. DIST. - JALPAIGURI
12. HOLDING NO. - 158 / 3062, 159 / 3063, 157 / 3061, 156 / 3065, 3058, 322 / 1738
13. APPROVED LUCC MEMO NO- 143/UC/ARPS/JDA DT- 22.06.12 & 3730/SIDA DT- 22.10.19

**GENERAL NOTES :-**

1. ALL DIMENSIONS ARE IN MM UNLESS OTHERWISE MENTIONED.
2. ALL EXTERNAL WALLS ARE 200 THK & INTERNAL WALLS ARE 125 THK.
3. ALL CHALKS ARE 100 THK & 450 MM PROJECTED.
4. DEPTH OF UNDERGROUND WATER RESERVOIR SHOULD NOT EXCEED THE DEPTH OF FOUNDATION.
5. GRADE OF CONCRETE & GRADE OF STEEL TO BE USED AS PER STRUCTURAL ENGINEER'S SPECIFICATION.
6. R.C.C. FRAMED STRUCTURE.
7. ANY DISCREPANCY IN SCALE, THE WRITTEN DIMENSION SHALL GOVERN.
8. FOR SPECIFICATION OF MATERIALS & WORKMANSHIP N.B.C. TO BE FOLLOWED.
9. OPEN TERRACE WITH LIME TREATING OF RATIO 2:17.
10. DAMP PROOF COURSE TO BE PROVIDED WITH C.P.C. (1:2:4).

**NOTE -1**  
#1 - FOR NON-COMBUSTIBLE ARTICLE

**NOTE -2**  
I shall maintain all the provisions for environmental clearance in future.

**CERTIFICATE OF ARCHITECT :**

I / We do hereby certify that the plans, elevations and sections and other structural details of the proposed building on Plot No. mentioned above under the jurisdiction of Siliguri Municipal Corporation have been prepared in conformity with the relevant provisions under the West Bengal Municipal (Building) Rules, 2007. This is also to certify that all relevant "No Objection" Certificates from the respective Authorities such as Fire and Emergency Services Department, Airport Authority, Pollution Control Board, Telecommunication Department, etc. as applicable in this regard, are also enclosed with the application for seeking approval of the plan to construct/reconstruct/addition/alteration of the building on the said plot.

**MITUL SHUKLA (B.ARCH.)**  
CA/2004/33251

**CERTIFICATE OF STRUCTURAL ENGINEER**

I / We do hereby certify that the foundation and superstructure of the building proposed for construction on Plot No. mentioned above under the jurisdiction of Siliguri Municipal Corporation have been personally inspected and as designed by me / us will make such foundation and superstructure safe in all respects including the consideration of bearing capacity and settlement of soil and other conditions, if any, conforming to the stipulation of all relevant IS Code of Practice and National Building Code.

(FOR SOIL ONLY)

**SANJIV J. PAREKH**  
M.E. (STRUCT.), M.C. (CONST. ENG.)  
B.C.E. (F-018202-4)  
E.S.E.-1-27 S.M.C.

**DECLARATION OF STRUCTURAL REVIEWER :**

I / We do hereby certify that the building proposed for construction on Plot No. mentioned above under the jurisdiction of Siliguri Municipal Corporation have been visited by me / us and all the designs, drawings Nos. 1, 2, 3, 4, 5 Soil Test Report and Load Test Results for foundation and superstructure have been duly reviewed conforming to stipulations of all latest relevant IS Code of Practice and National Building Code and it is found that everything is completely in order and the proposed foundation and superstructures are safe in all respect.

**DECLARATION OF OWNER :**

I do hereby declare that the building proposed for construction shall be supervised by the BA/LBS signing the building plan application or in his absence by any other BA/LBS of the appropriate category and as approved by the authority.

**Manoj Sheela & India Pvt. Ltd.**  
Harsh Bhatia, Director

**OWNERS DETAIL :**

Manoj Sheela & India Pvt. Ltd. Represented by Director Harsh Bhatia

Shi Sushil Kumar Baria	Wife of Shi Sushil Kumar Baria
Smt. Manju Devi Baria	Son of Shi Sushil Kumar Baria
Shi Harsh Baria	Son of Shi Sushil Kumar Baria
Shi Deepak Baria	Son of Shi Sushil Kumar Baria
Shi Gaurav Baria	Son of Shi Sushil Kumar Baria

**PROJECT :**

**PROPOSED PLAN OF (G + XI) STORED RESIDENTIAL BUILDING AT MOUZA - DAGGRAM, J.L.NO. - 02, WARD NO.-41(S.M.C.), P.S.-BHAJANTINAGAR, PRGN.-BAIKUNTHAPUR, 2ND MILE SEVOK RD, SILIGURI, DIST.-JALPAIGURI**

**TITLE :**

**OVERALL 1ST FLOOR PLAN & OVERALL 2ND FLOOR PLAN**

SCALE : 1:200      DRAWN BY : HAIMANTY      CHECKED BY : PAPIA

DATE: 28.08.2020      DRG. NO. : MA/285/SMC/02

**MASS & VOID**  
ARCHITECTS / INTERIORS

48, 4th Floor, Chitra Habitat,  
54, Christopher Road, Kolkata-700 046  
P +91 31 2338 2266  
E massvoid@gmail.com  
H www.massandvoid.com

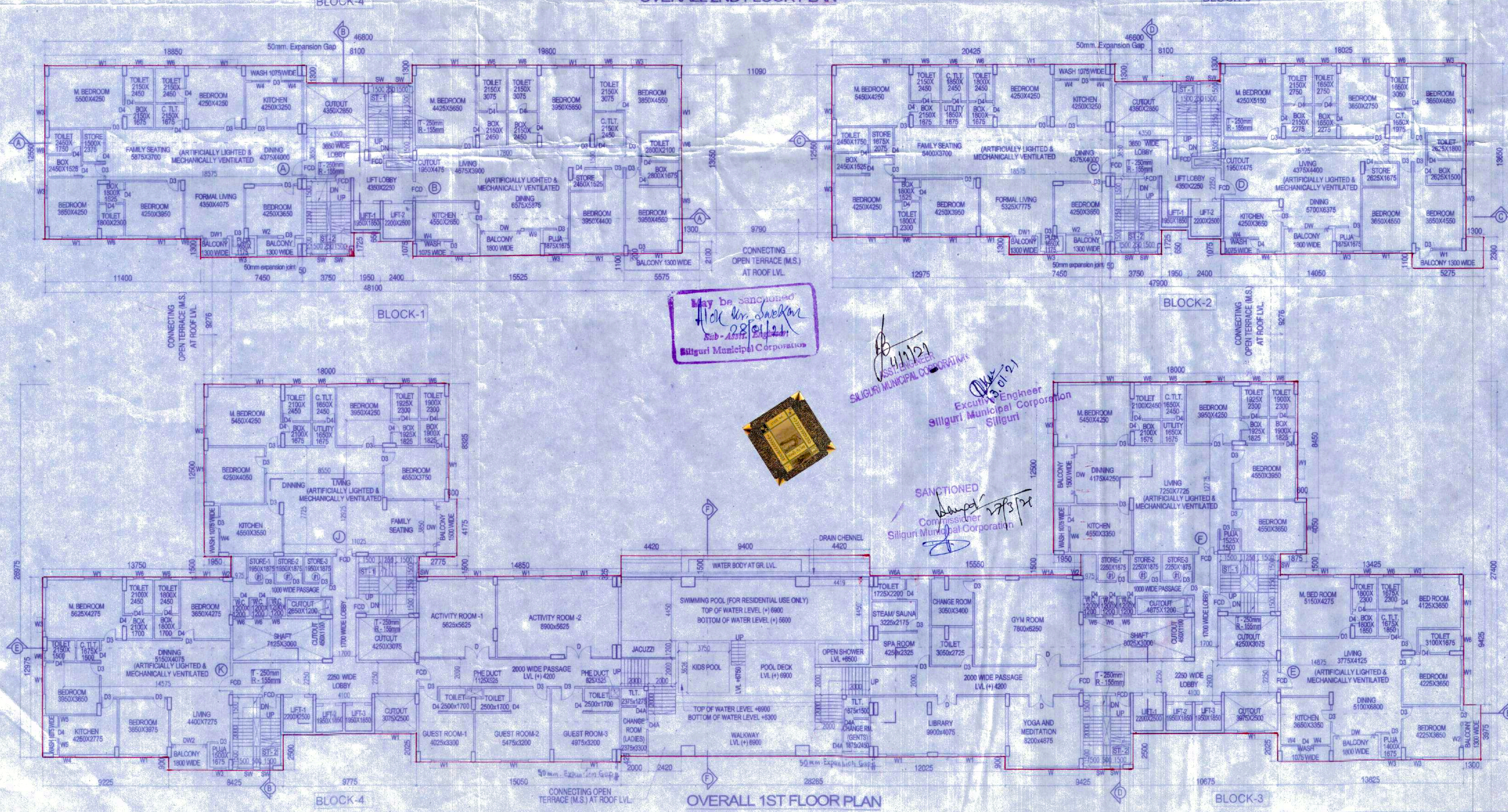
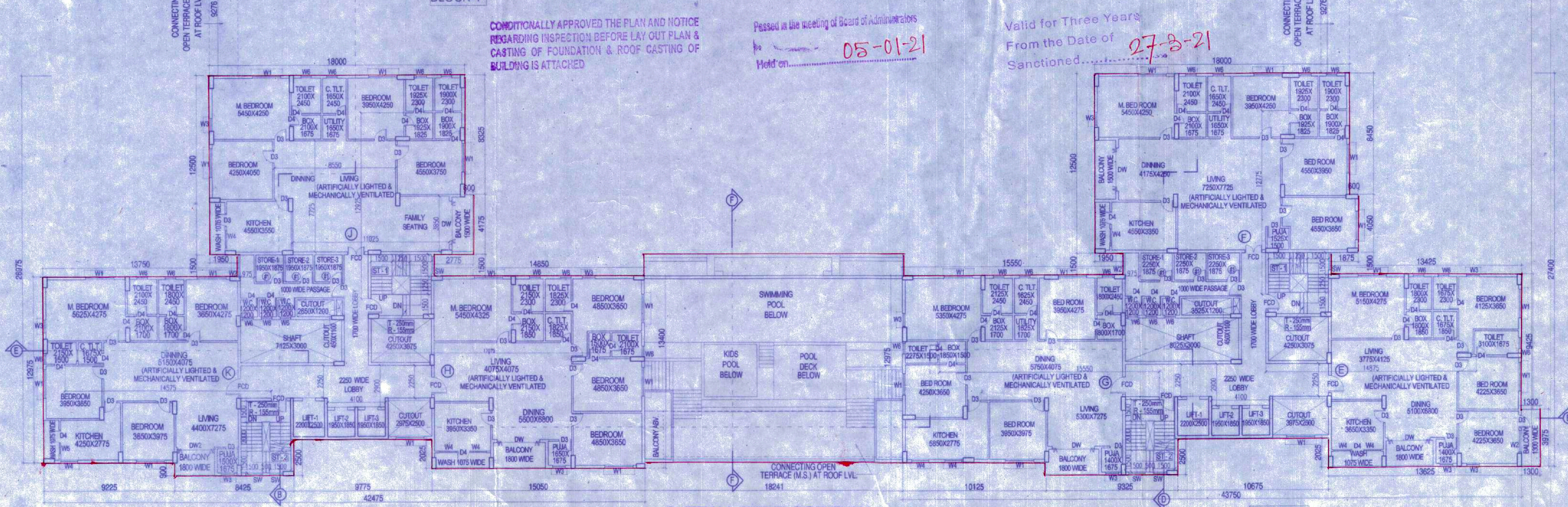
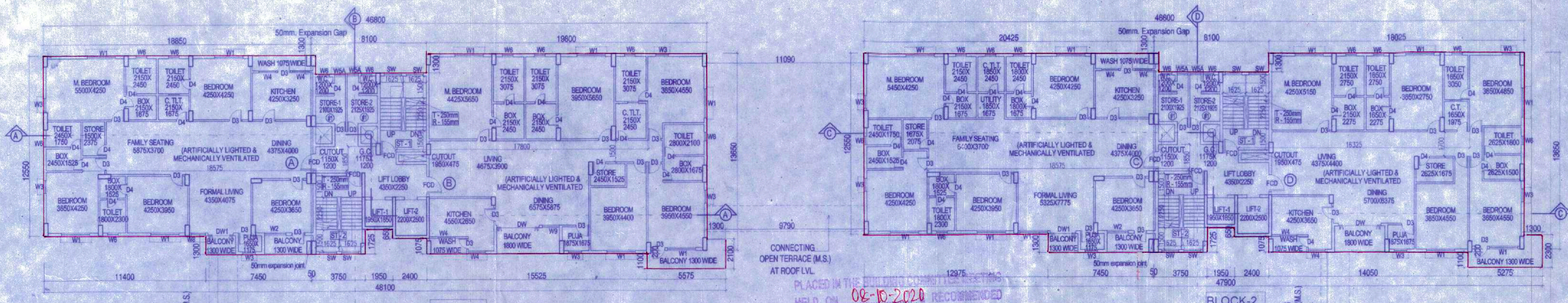

PLACED IN THIS BUILDING  
HELD ON: 08-10-2020 RECOMMENDED

Valid for Three Years  
From the Date of Sanctioned: 27-8-21

Pressed in the meeting of Board of Administrators  
Held on: 05-01-21

CONDITIONALLY APPROVED THE PLAN AND NOTICE REGARDING INSPECTION BEFORE LAY OUT PLAN & CASTING OF FOUNDATION & ROOF CASTING OF BUILDING IS ATTACHED

THIS PLAN IS CONDITIONALLY SANCTIONED THAT NO OBJECTION CERTIFICATE FROM FIRE SERVICE IS REQUIRED BEFORE OCCUPANCY CERTIFICATE

May be sanctioned  
Held on: 08-10-2020  
Siliguri Municipal Corporation

Sanctioned  
Comptroller  
Siliguri Municipal Corporation

